

5

Car washer



# Contents

- 51、Product Introduction
- 52、Product Parameter
- 53、Product Description
- 54、Wireless Model Use Methods
- 57、Wired Model Use Methods
- 58、Washer Cannon Safety Warning
- 58、Attention
- 59、Suggested Car Washing Method
- 60、How to use foam watering can
- 61、Frequently Asked Questions

# Product Introduction

wireless Car washer is a convenient and bulk cleaning equipment with small volume and large water pressure. Although it is small in size, it can have great water pressure thanks to the excellent water pump structure design of engineers. The washer cannon is equipped with 0-degree and 40-degree water nozzles to meet different cleaning needs. Its convenience also lies in the convenience of taking water, connecting special water pipes, and taking water through buckets, mineral water bottles, tap water and other ways

In addition to daily car washing, it can also meet various cleaning requirements in life, such as cleaning balconies and roads through high water pressure, or watering gardens and vegetable fields, etc. Hope it can become a good helper in our daily life

Some models of Power Bank are also equipped with USB output, wireless charging of mobile phones and other very practical functions in life.

# Product Parameter

Parameters may change with product upgrade, please understand

Model	BY-XCJ01	Motor	All copper motor	Power supply	Power Bank/cigarette lighter
Current	About 200-240L/H	Water type	6 water shapes	Water pump	Ultra-high pressure three-plunger metal pump
DC	DC-5525-12V	Contact	12V	Voltage	12V
stress	200Psi	distance	6-8m	Motor power	130w

Material ABS + aluminum + stainless steel + copper

Sizes approximately 400mm\*180mm\*87mm

Weight is about 950g (No Power Bank)

battery life:

Power Bank 150 (about 30minutes), Power Bank192B (about40minutes)

Parameters of Power Bank: Please refer to some instructions of Power Bank (pages 1-15)

# Product Description

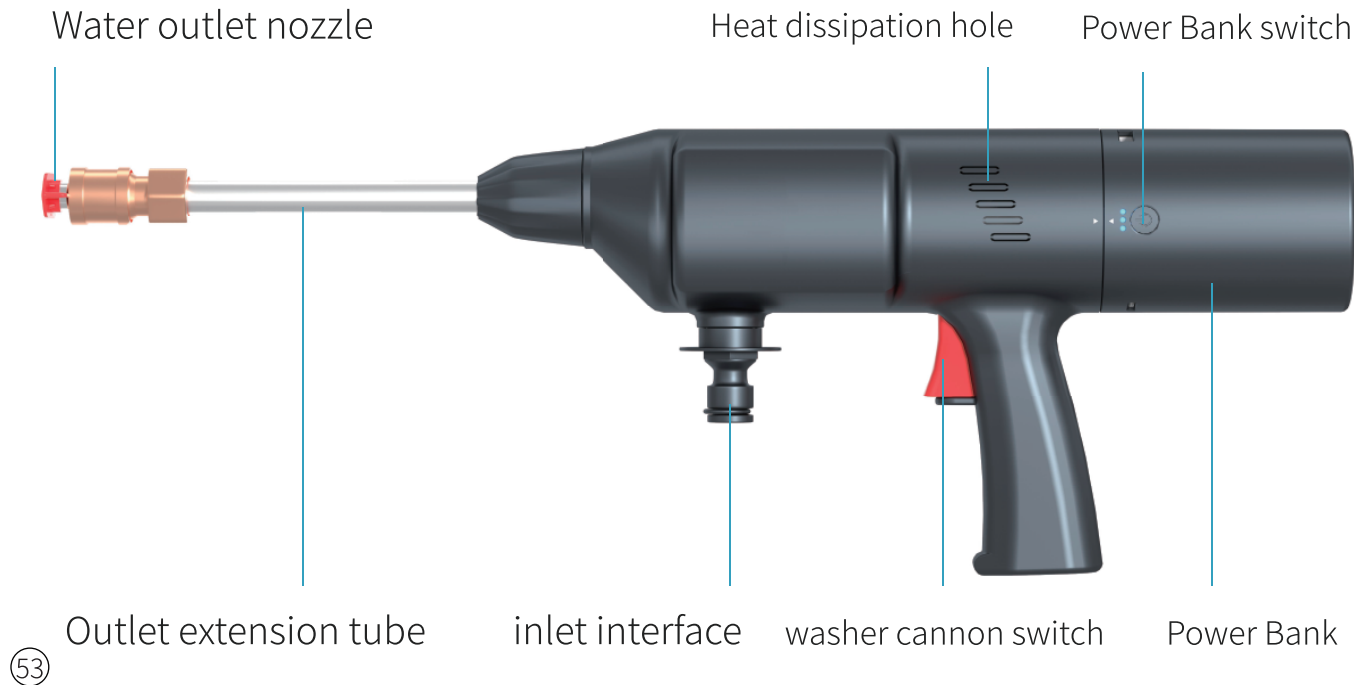

# Wireless Model Use Methods

1. Remove the decorative ring of the power bank, align the unlocking mark of the power bank with the small triangle mark at the installation interface of the car washer, and then connect it. Then rotate the power bank to the right to align the locking mark of the power bank with the triangle mark of the car washer, indicating that the installation is complete.

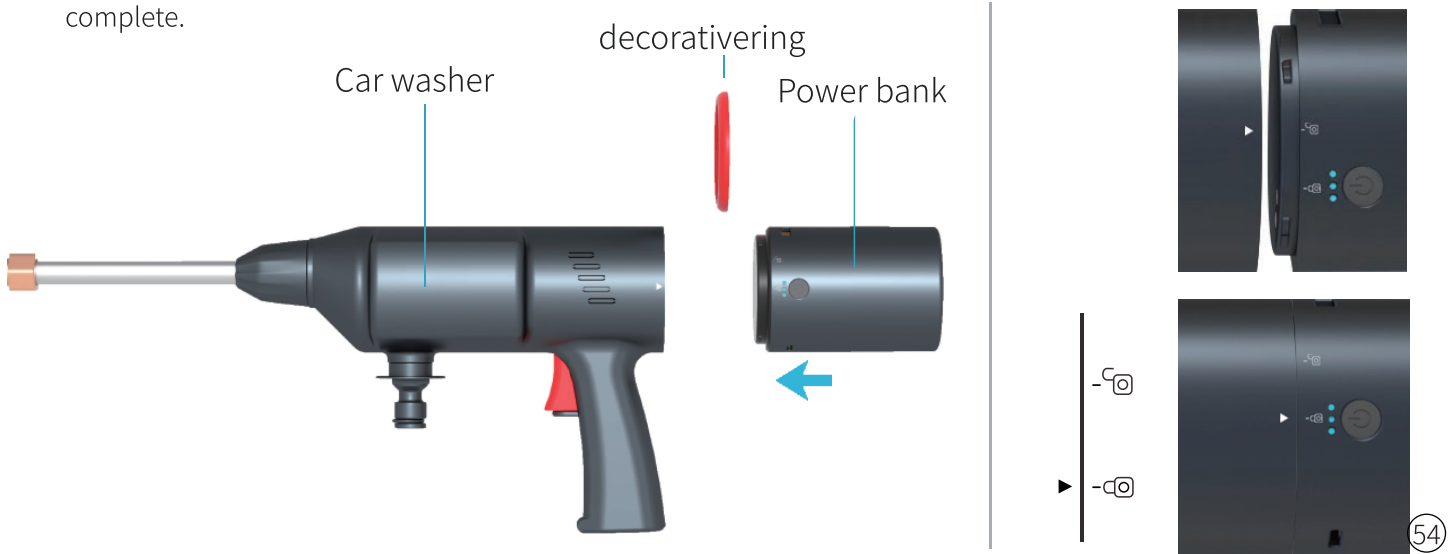

2. The extension tube is rotationally connected to the water outlet of the Car washer, and the water tube interface is connected to the water inlet of the Car washer.
3. Put the filter screen at the other end of the water tube into a bucket full of water, or directly put it into a clean river or stream with no urgent water flow. (See Page 61 for details.)

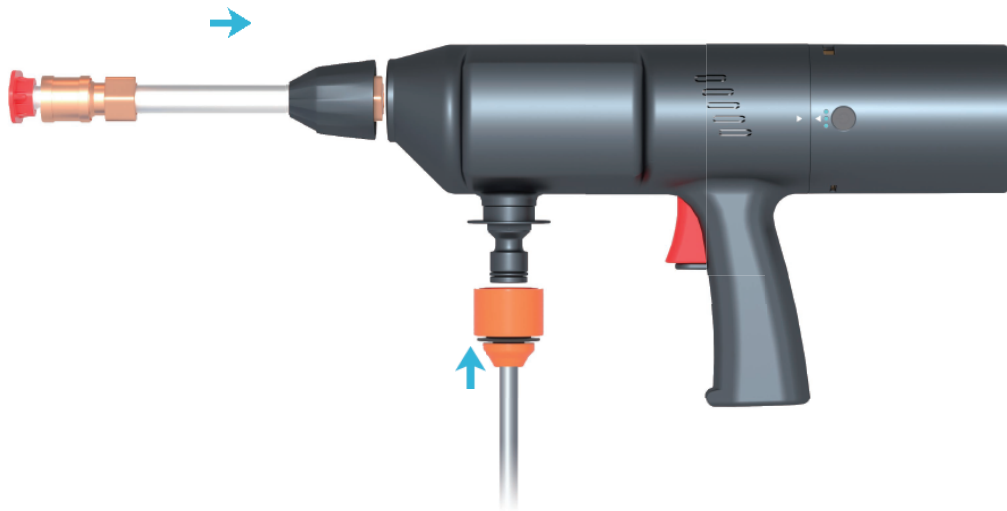

4. Press the 01 power switch on the Power Bank, and then press the 02 red switch beside the handle of the Car washer, and the water outlet tube can discharge water at high pressure.

5. The nozzle is equipped with two water shapes, 0 degree and 40 degree respectively. When replacing the nozzle, please slide the copper interface on the extension tube backward to take out the original nozzle for replacement.

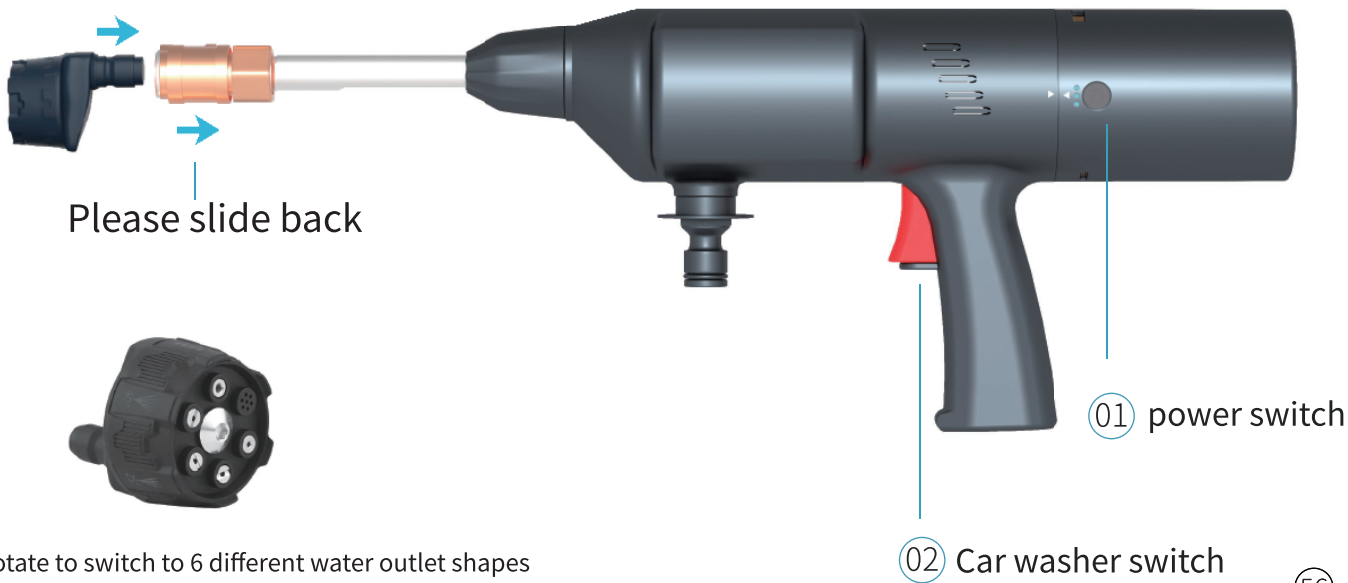

# Wired Model Use Methods

1. When the Power Bank is not purchased or the Power Bank is short of electricity, the configured vehicle-mounted cigarette lighter line can be directly used to directly supply power to the Car washer.
2. Insert the lighter head of the line into the vehicle-mounted cigarette lighter interface, the DC interface at the other end and the DC seat interface at the rear of the Car washer handle to power on.

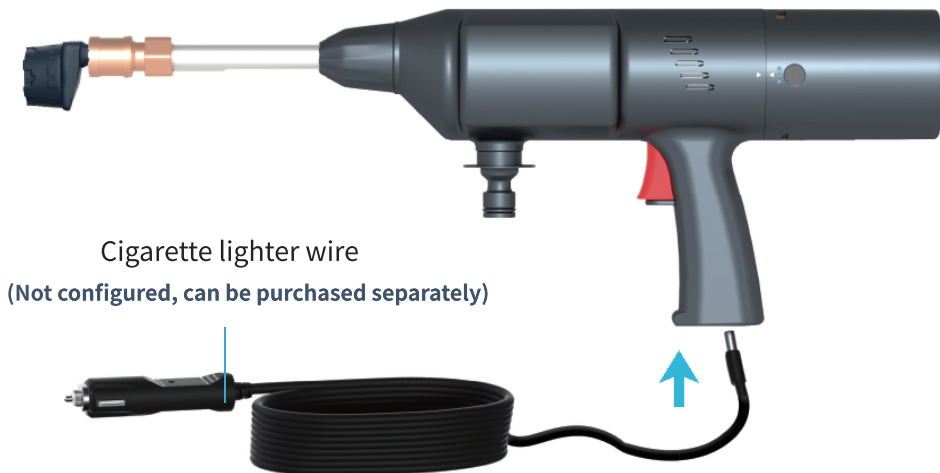



## Washer Cannon Safety Warning



Please read the following warnings and instructions carefully. Failure to comply with the warnings may lead to damage to people and things.

1. It is not allowed to shoot high-pressure water at others or various parts of human body.
2. It is not allowed to inject water into device containing electrical components.
3. To ensure product safety, please use the accessories provided or approved by our company.
4. Disconnect the energy bank after use and before user maintenance or cleaning.
5. Keep the Car washer out of reach of children when electrifying.
6. When the Car washer accidentally falls to the ground, it should be stopped when there is visible damage or leakage on it.
7. When connecting the Power battery, the Car washer should not be left unattended.

## Attention

- (1) Before storage, please completely drain the water in the machine and water tube.
- (2) Please wipe the body with a soft brush or clean cloth.
- (3) Do not use water, solvent or polishing agent.
- (4) Please keep the machine in a safe and dry place and avoid children's contact.
- (5) Do not place other items on the machine.
- (6) When storing machines and accessories, please pay attention to frost prevention.

# Suggested Car Washing Method (for reference only)



1. Clean the floating sand on the surface of the car paint with the high-pressure water from the Car washer and wet the car body.



2. Pour car wash powder or car wash liquid into the foam watering can, add clear water in proportion and shake well.



3. Connect the foam watering can to the interface on the extension tube of the Car washer, and spray foam on the whole car body.

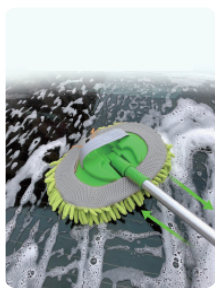

4. Wipe the car body with sponges, soft brushes, car wash mops and other tools.



5. Rinse the car body with the Car washer.



6. Dry the water marks on the car body with a towel

# How to use foam watering can

(1) Pour the car wash liquid into the watering can, or pour the car wash powder into the watering can, add the right amount of water and shake it to dissolve, It can be connected to the car washing machine as shown in figure (2).



(2) Slide the extension tube backward, take out the nozzle, and replace the foam watering can

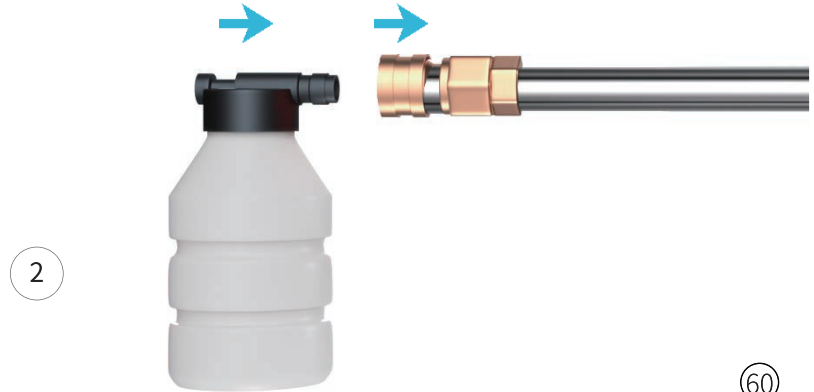

# Frequently Asked Questions

Fault	Solutions
The nozzle leaks or the outlet pressure suddenly increases	The nozzle is blocked. Please clean the blockage or replace the nozzle before using it
Water came out after the machine was shut down	After the machine is shut down, there is water residue in the pump door, and the water is completely discharged before
Foam pot can't spray detergent	The foam pot is blocked and cleaned with water
The machine can't suck water by itself or lack of pressure	(1) If the machine is too high from the water source surface, lower the machine to less than 1.5 meters from the water source surface
	(2) If the water tube filter is blocked, take out the water tube filter and clean up the sundries with water
	(3) If the self-provided water tube is not well combined with the machine, check and reinstall the water tube
	(4) The tube joint is loose and the tube is not in place
	(5) Pumps, water tubes or other accessories are frozen and reused after thawing
The new machine won't start or stop automatically	(1) Please check whether the Power battery is installed in place. If there is no electricity or it is broken, please charge or replace it with a new Power Bank
	(2) The motor overheating device will automatically cut off power protection according to the temperature and voltage of the internal motor